



WALKER PARK - OPTION 4

BUR22WAL4-4-2 • 06.28.2022



LS
landscape
structures

WALKER PARK - OPTION 4

BUR22WAL4-4-1 • 06.28.2022

©2022 Landscape Str

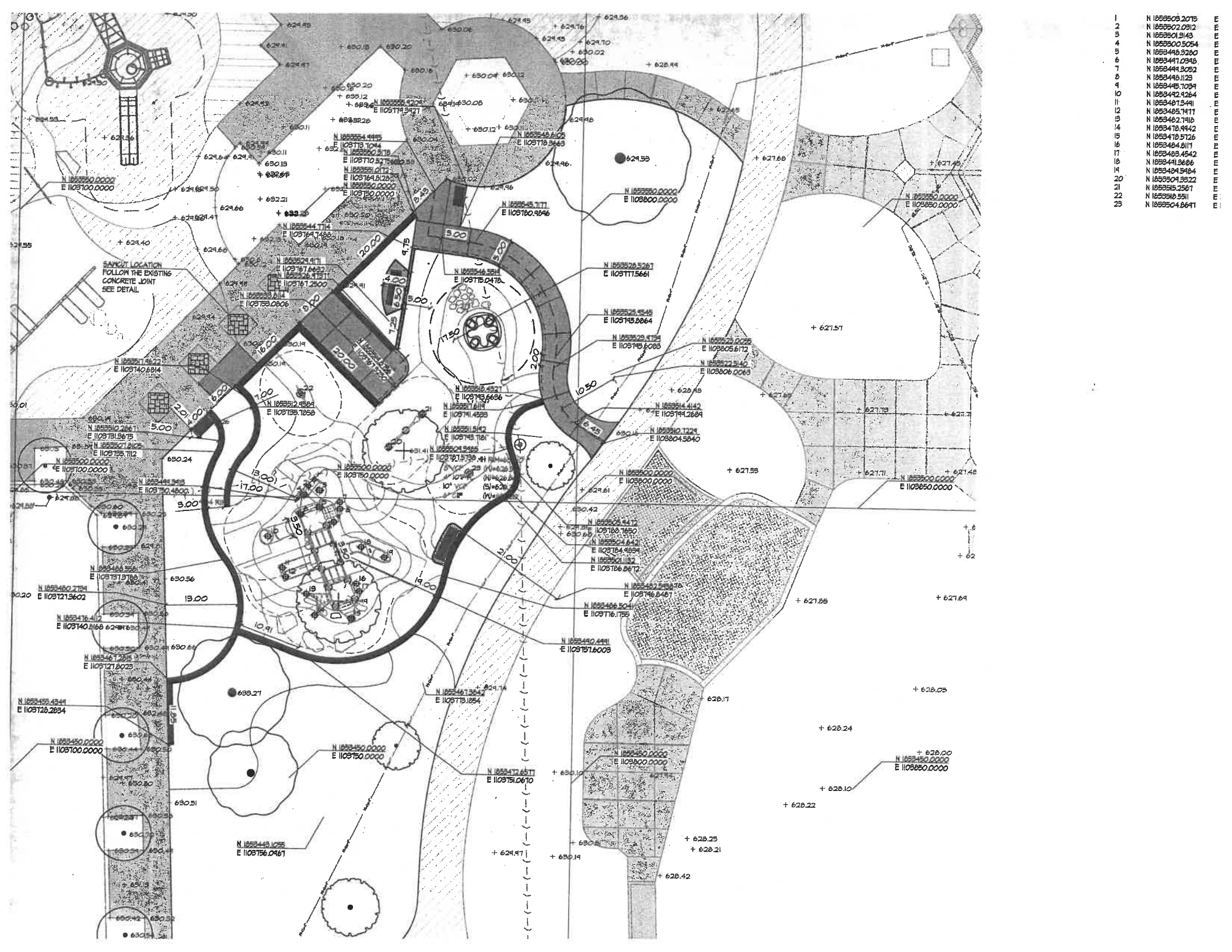

1	N 102550.2075	E
2	N 102550.20912	E
3	N 102550.9143	E
4	N 102550.5054	E
5	N 1025446.3260	E
6	N 1025441.0348	E
7	N 1025441.3052	E
8	N 1025446.1123	E
9	N 1025446.1034	E
10	N 1025442.4264	E
11	N 1025481.3491	E
12	N 1025485.1411	E
13	N 1025462.1416	E
14	N 1025478.9442	E
15	N 1025478.5126	E
16	N 1025484.8111	E
17	N 1025485.4542	E
18	N 1025441.3686	E
19	N 1025484.5484	E
20	N 1025504.5522	E
21	N 1025545.2567	E
22	N 1025546.5511	E
23	N 1025554.8641	E

SAPNET LOCATION
FOLLOW THE EXISTING
CONCRETE JOINT
SEE DETAIL.

N 102550.0000
E 110250.0000

N 102551.9672
E 11025140.6814

N 102550.0000
E 11025100.0000

N 1025460.2784
E 11025121.3602

N 1025455.4344
E 1102528.2834

N 1025450.0000
E 11025100.0000

N 1025450.0000
E 11025100.0000

N 102554.1445
E 1102578.1044

N 102554.7174
E 1102574.7488

N 102552.14584
E 1102578.7858

N 1025443.1055
E 1102576.0461

N 102554.8102
E 1102578.3443

N 102554.5381
E 1102578.0478

N 102554.4327
E 1102574.6636

N 1025461.3647
E 1102578.1854

N 1025472.6571
E 1102575.0670

N 102554.8102
E 1102578.3443

N 102555.1171
E 1102580.4846

N 102552.4795
E 1102578.6085

N 102551.8147
E 1102578.7181

N 1025466.5041
E 1102576.1759

N 1025440.4481
E 1102578.6008

N 102550.0000
E 1102800.0000

N 102552.6261
E 1102577.5661

N 102552.4548
E 1102543.8864

N 102552.4795
E 1102578.6085

N 102552.5140
E 1102806.0063

N 102554.4142
E 1102594.2684

N 102550.0000
E 1102800.0000

N 102552.5417
E 1102583.1450

N 102552.4421
E 1102584.4634

N 102552.1132
E 1102586.8472

N 1025482.515476
E 11025746.8481

N 1025450.0000
E 1102800.0000

N 1025450.0000
E 1102800.0000

N 1025450.0000
E 1102800.0000

N 1025450.0000
E 1102800.0000

N 102550.0000
E 1102800.0000

N 102550.0000
E 1102800.0000

N 102550.0000
E 1102800.0000

N 102550.0000
E 1102800.0000

N 102550.0000
E 1102800.0000

N 102550.0000
E 1102800.0000

N 102550.0000
E 1102800.0000

N 102550.0000
E 1102800.0000

N 102550.0000
E 1102800.0000

N 102550.0000
E 1102800.0000

